

ALTITUDE

ALICE PAMPHLET — N°5

ALTITUDE
2008

ALICE PAMPHLET
N°5

ALTITUDE

ALTITUDE



ALICE

altitude

lausanne / 2008

EPFL / ENAC / IA / ALICE

atelier de la conception de l'espace

fall semester 2008

dieter dietz, aline, dubach, olivier otteavere, daniel pokora, isabella pasqualini, katia ritz



contents

altitude	8
terre meuble	11
built section	21
flat forms	25
visible world	31
team	38
acknowledgments	39

In semester 3 of the academic year 2008/2009 the ALICE studio developed projects along the newly opened m2-metro-line in Lausanne. The guiding topic in the ALICE curriculum was altitude.

Altitude locates us in a relative position in respect to the surface of our planet. It therefore addresses fundamental questions such as ground and gravity and presents a precise framework for a conscious process of designing an architectural tectonic project.

The studio developed inhabitable structures upon increasing heights. In learning how the environment is changing along a scale ranging from depth to high altitude (e.g. the change of pressure), we investigated how such shifting conditions can inform and impact on the conception of a responsive architecture project. At the same time we measured those conditions against our bodies by introducing a singular program performing adaptively at various heights.

The investigations are conducted by the means of the traditional tools of the architect: model, plan, section, as well as through the parallel implementation of computational technologies (2d and 3d modeling software).

The first-semester course is designed to give an introduction into investigations addressing space, scale, materiality, geometry and program. Through the course of the semester, the class developed design proposals in groups of 2 for an inhabitable platform performing specifically at different heights.

In the first week, each group had to invent a physical device measuring altitude. This device was to measure height and/or depth both as a local condition as well as to register altitude as a relative position in reference to the surface of the earth.

10

terre meuble
At the same time the device was to be able to record, amplify, or — more generally speaking — react to pressure.

11



12

13

WK 38 19SEPT

Altimeter

Hemispherical device recording silhouettes and angular conditions of contours

Vy Pham Thi Hoang, Nicolas Fehl

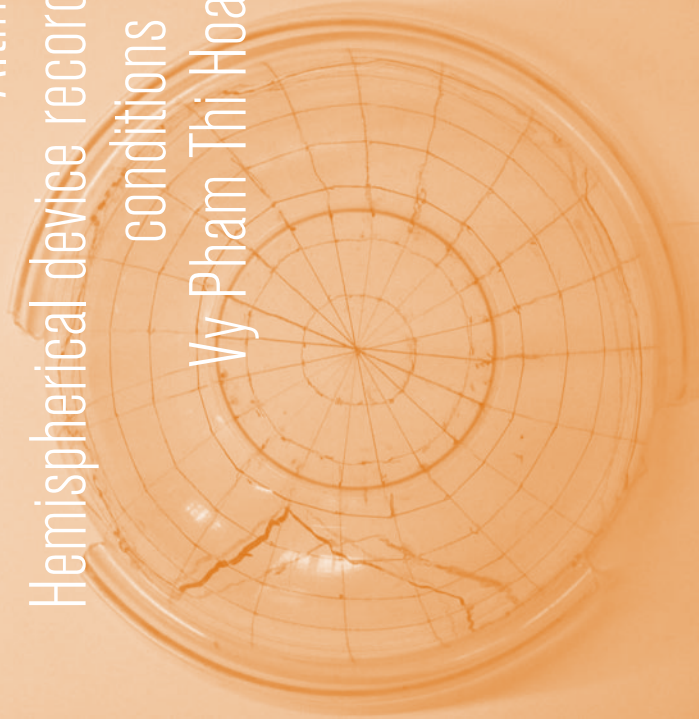

14



6

WK 39 27SEPT

A bicycle transformed in a recording device, and the model derived from the data. Danny Te Kloese, Youcef Mezzour

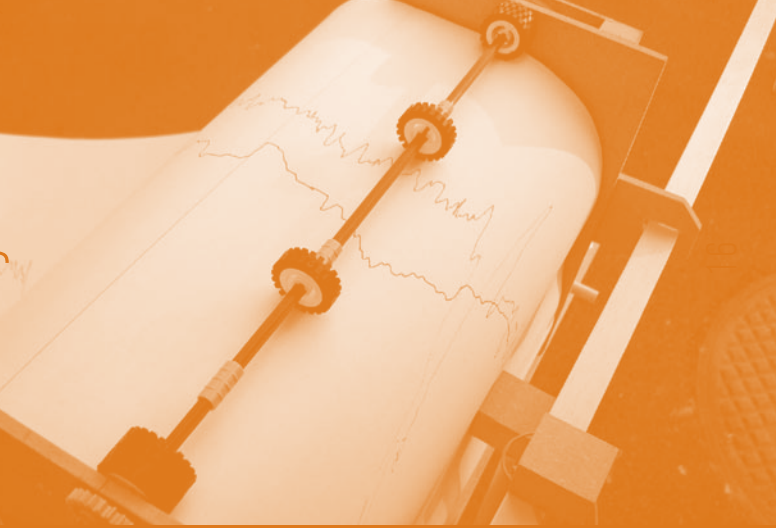
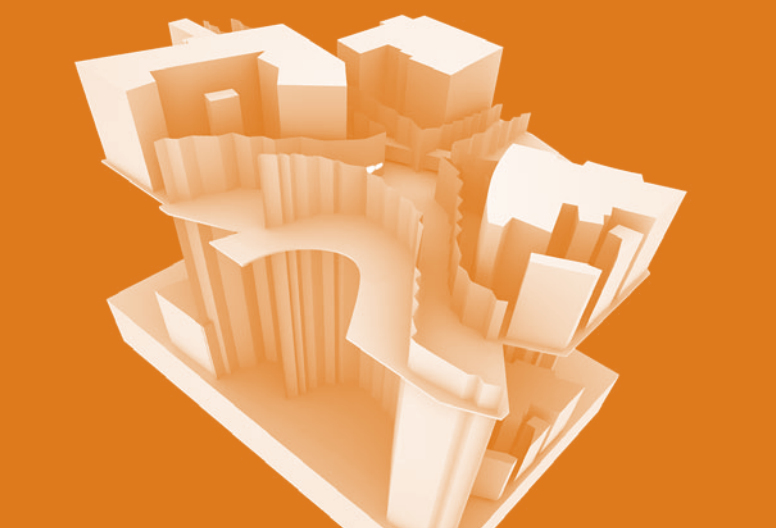

WK 40 20OCT

Conceptual model translating a topographical condition: Lausanne Flon
Samuel Devanthery, Benjamin Melly

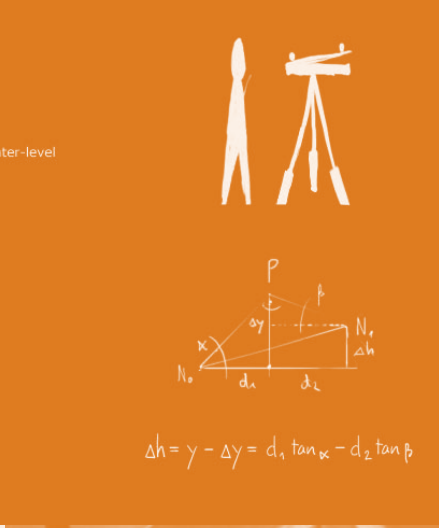
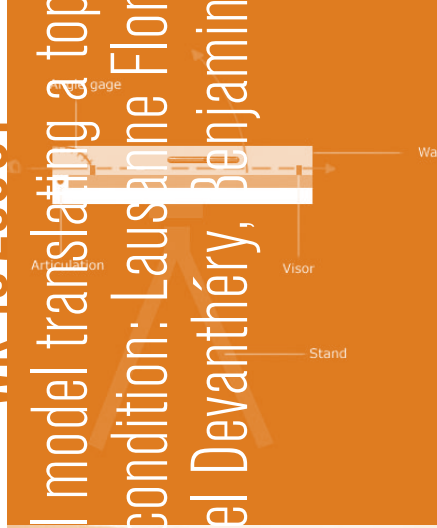

WK 41 80CT

Data derived from surveys with a cart recording device

Augustin Clement, Martin Lepoutre

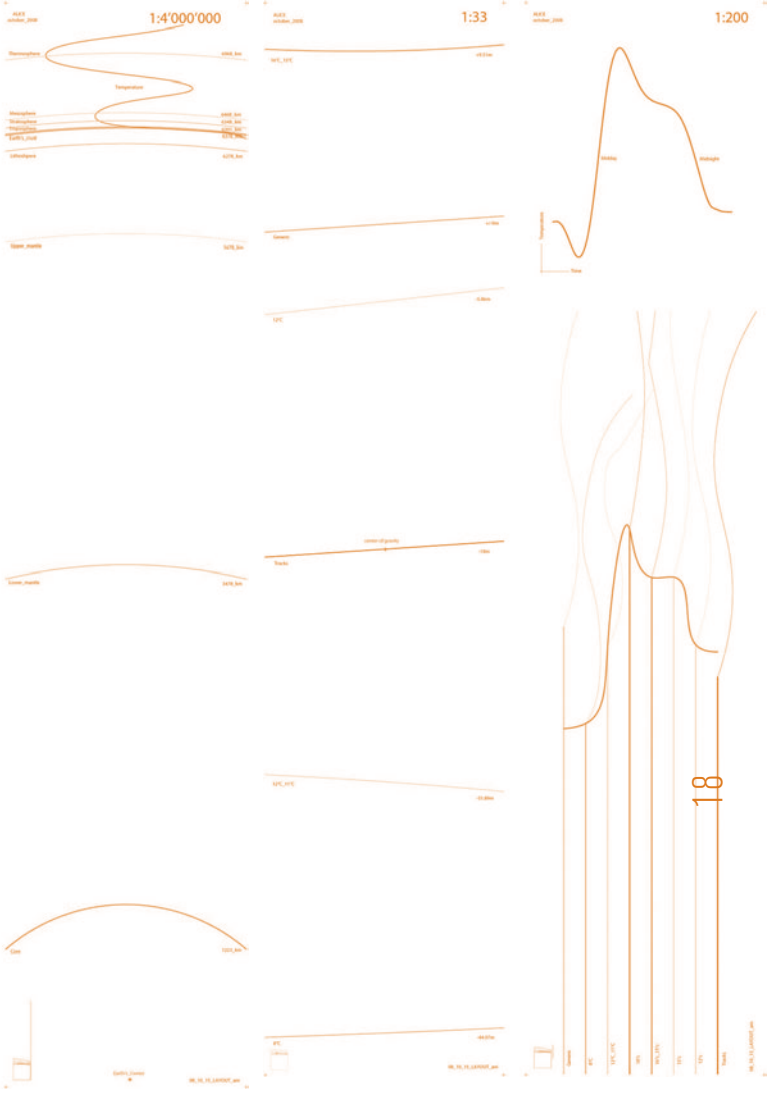

terre meuble

The altimeter was used to record heights in a given site and to draw sections accordingly. Drawing here was introduced as an instrument of analysis. This study in the form of a sequence of sections (for example tomographic) was focusing on the performance of the altimeter rising from a specific depth to various heights and the sectional condition of the given site.

WK 42 150GT

Built section

Augustin Clement, Martin Lepoutre

Fabian Roth Simon Walti



built section

While the drawing exploration was ongoing, the students were extracting in parallel working models from the drawing sequence: a physical model as a reinterpretation of the drawings in the form of a built section. Emphasis was put on the found data in the site in relation to data referring to the altimeter.

The program of passage was introduced to link different data and in both drawing and the 1/33 model.

WK 45 5N0V

Scalar operations introduce inhabitable space
Julien Prudhomme, Carole Westhoff

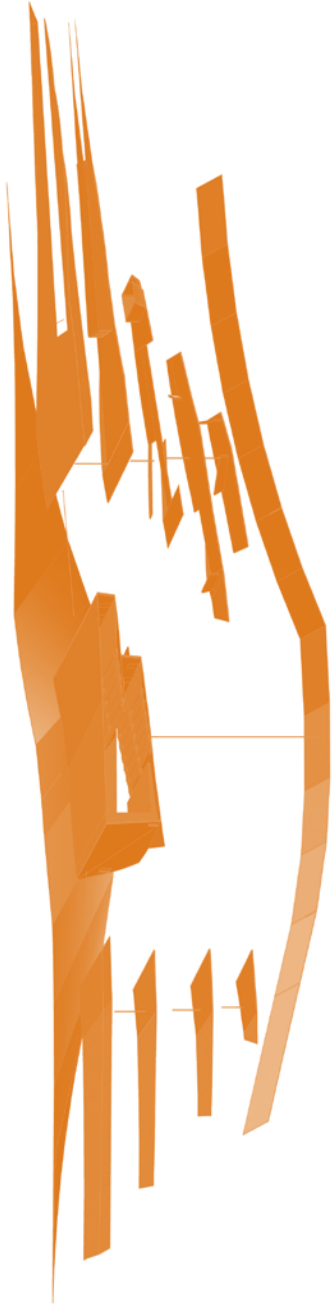

22

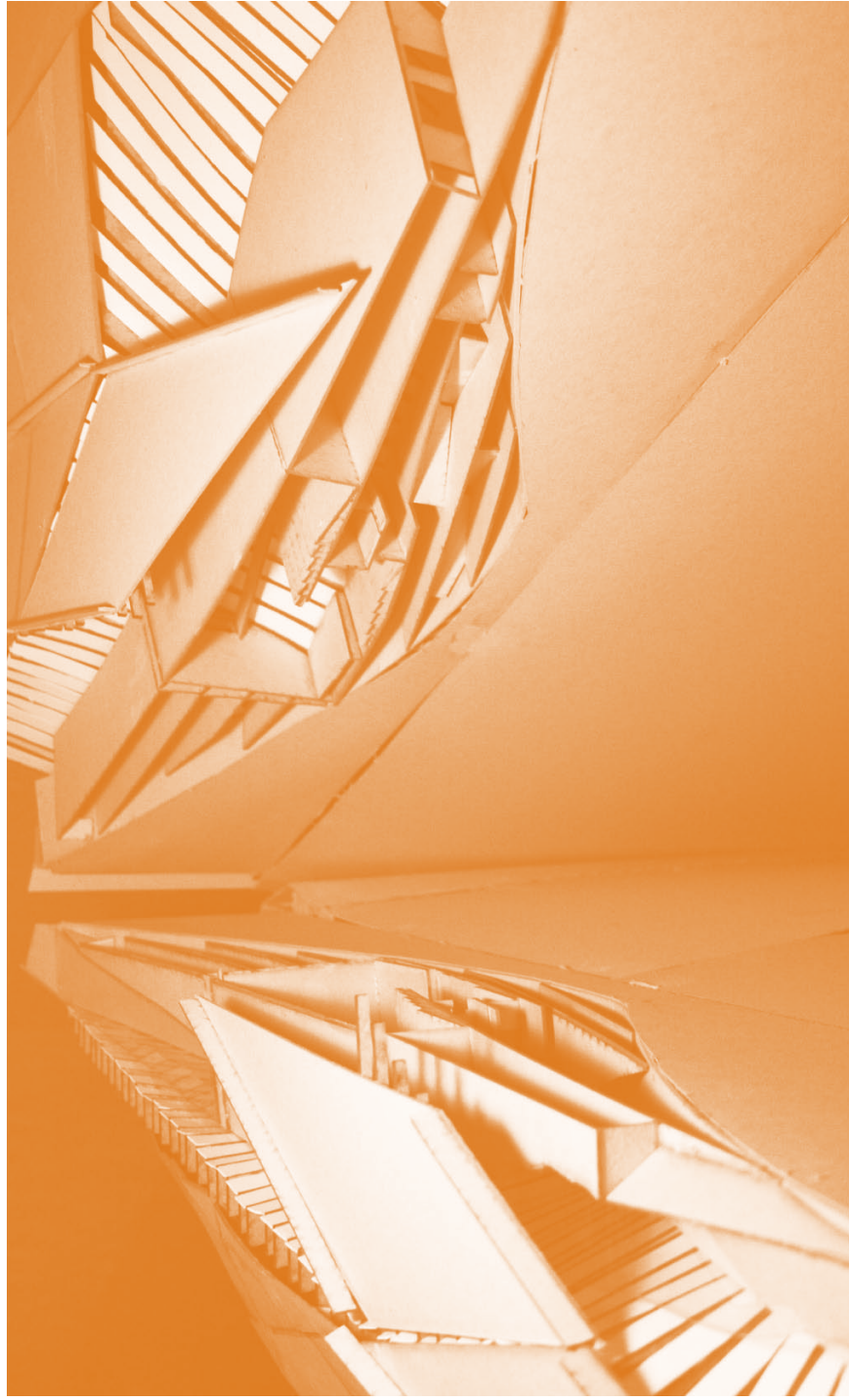

23

In a first part focus was set on responding to the prototypical site, the program, and the responsive scale of the platform and speculate on how the public will interact with the proposed program.

flat forms In a second part we were elaborating on a comprehensive structural system and on an assembly of building systems and choices of materials.

WK 46 12 NOV

Climbin wall at Lausanne
Samuel Maire, Olivier Di Giambattista

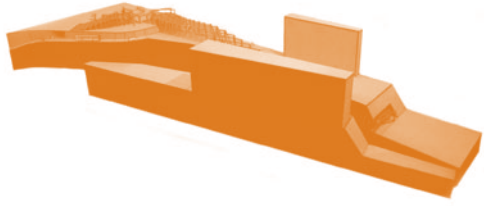
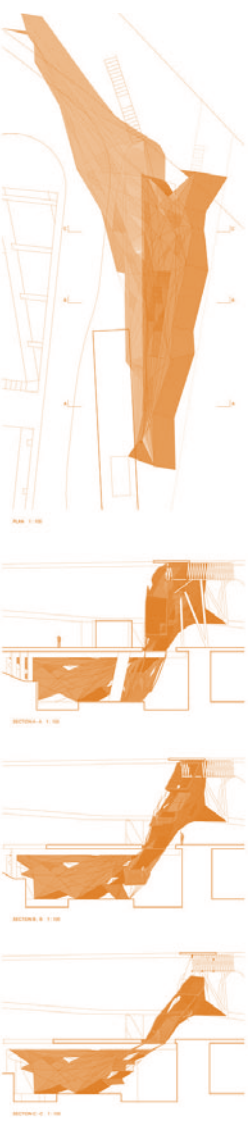

WK 47 19NOV

A New Passage at Lausanne Ours
Danny Te Kloese, Youcwf Mezzour

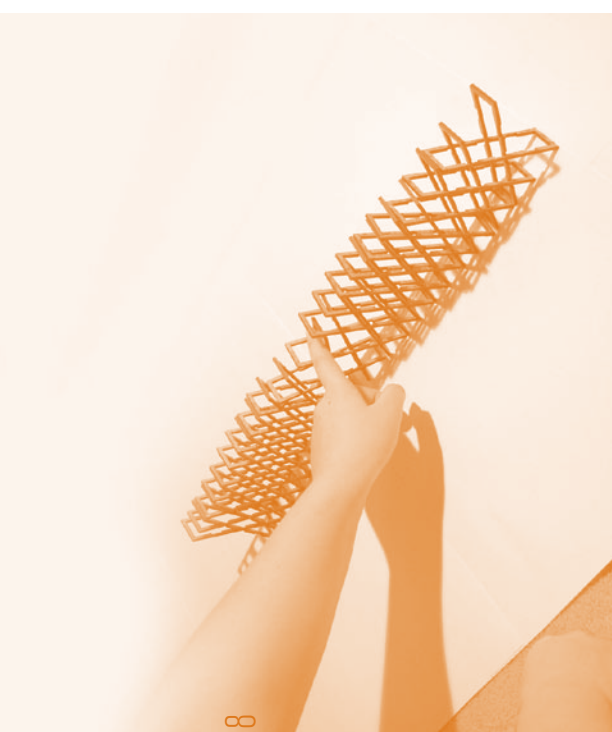

28



29

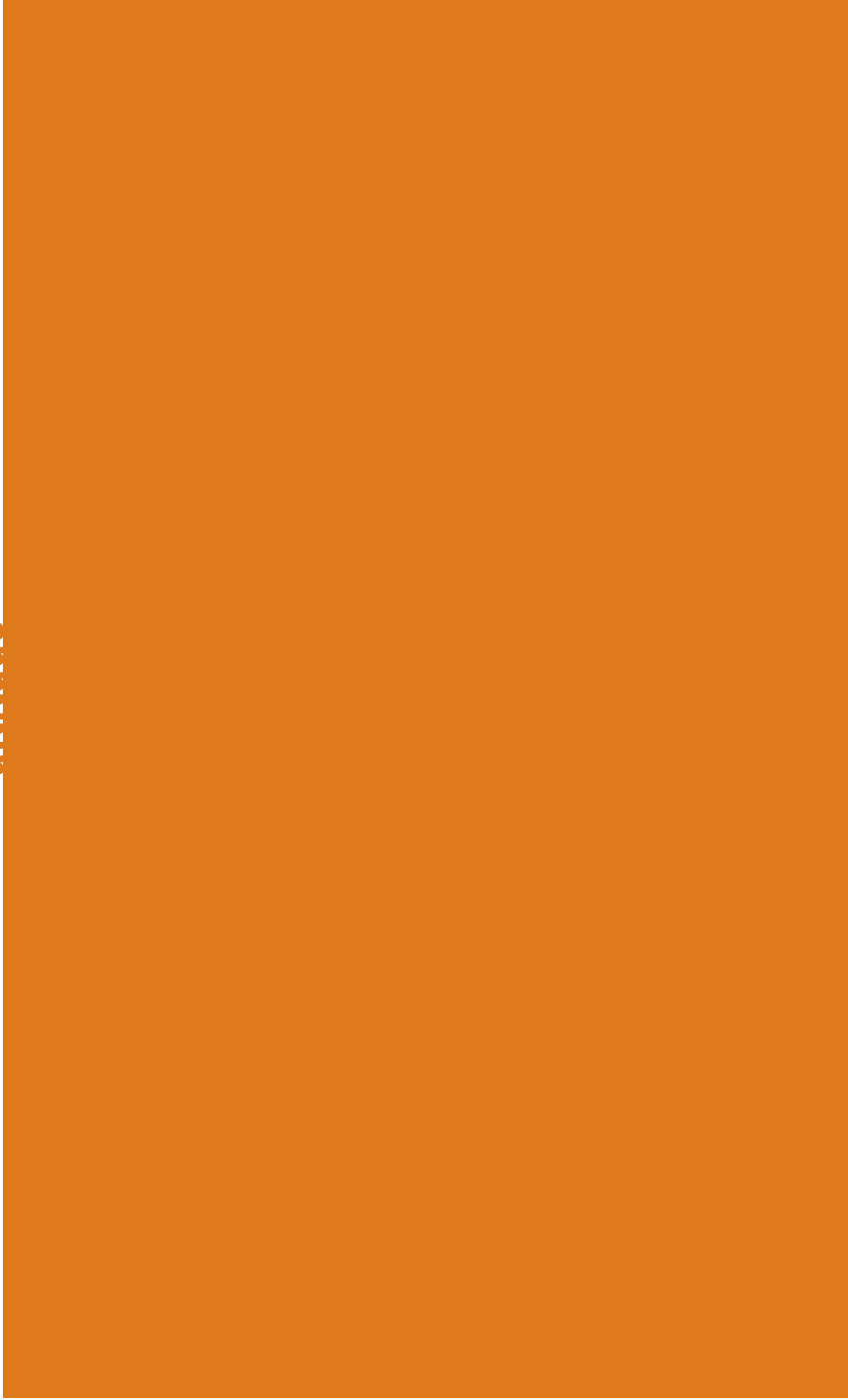

The semester concluded with a three weeks charrette in which the proposed concepts and programs of the design proposal projects were revisited and articulated to become a comprehensive architectural project.

WK 49 3DEZ

Greenhouse Intervention
Augustin Clement, Martin Lepoutre



32

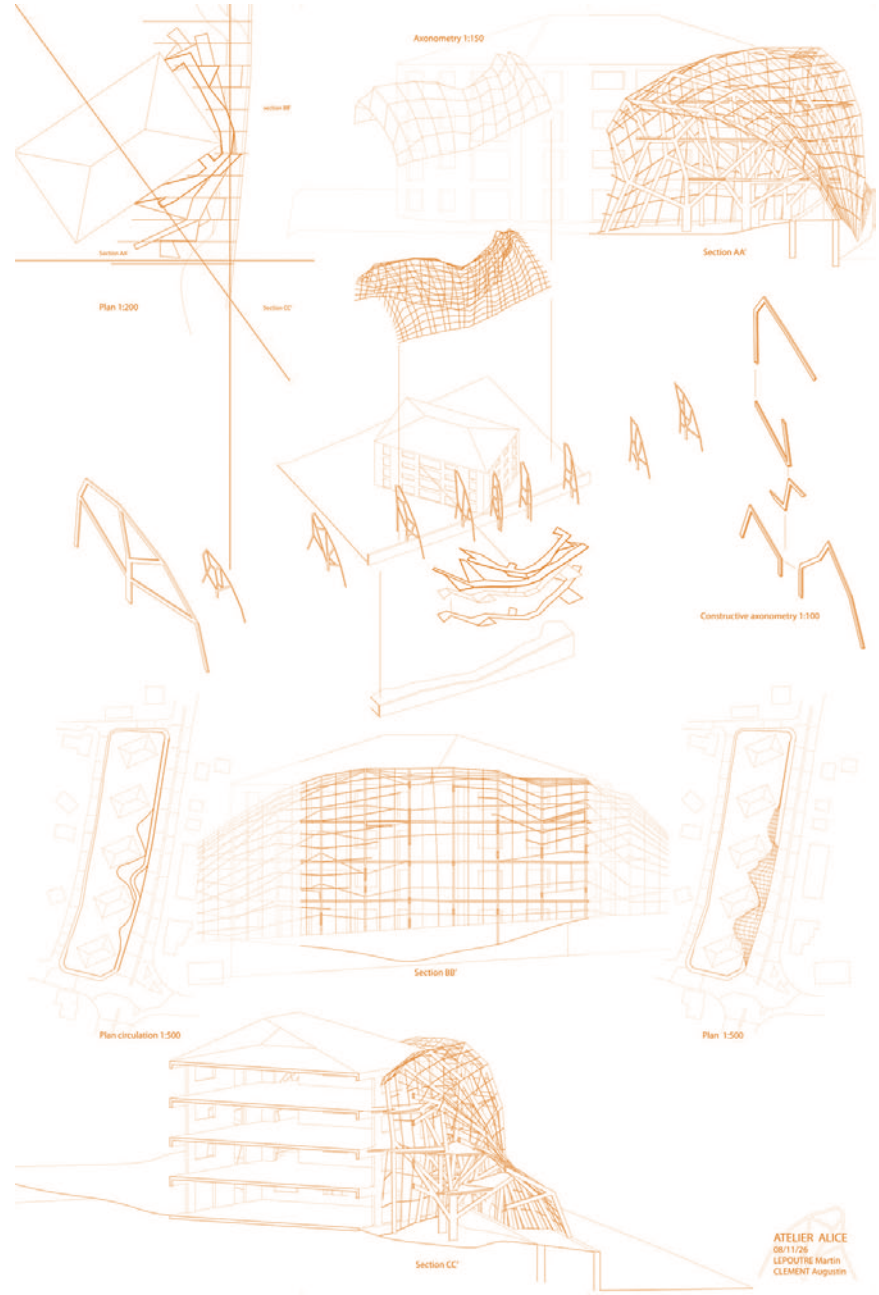

33

Maurice Béjart Spa

Alexandria Ming Aerni, Ahmed Belkhadja

ALICE0809 Final Presentation: a spa at Bessières, Lausanne

Site Plan 1:500

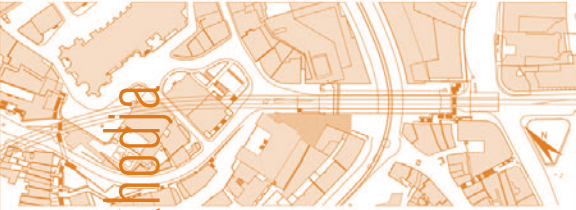

Section 1:500



Elevation 1:100

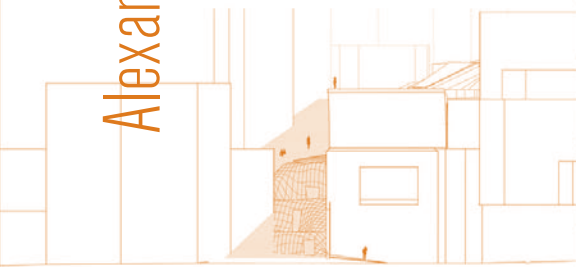

ALICE0809 Final Presentation

Axonometric View 1:150

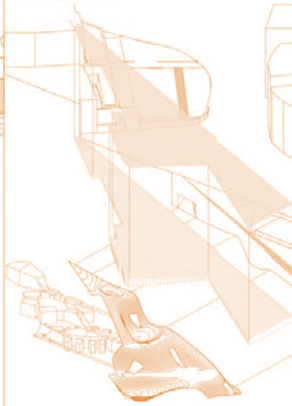

Plan Floor entrance level 1:200



Plan therapy level 1:200



Plan secondary pool level 1:200



Plan Cité entrance level 1:200



Inverted Pier at Lausanne Ouchy
Lionel Epiney, Adrien Llewelyn Meredith

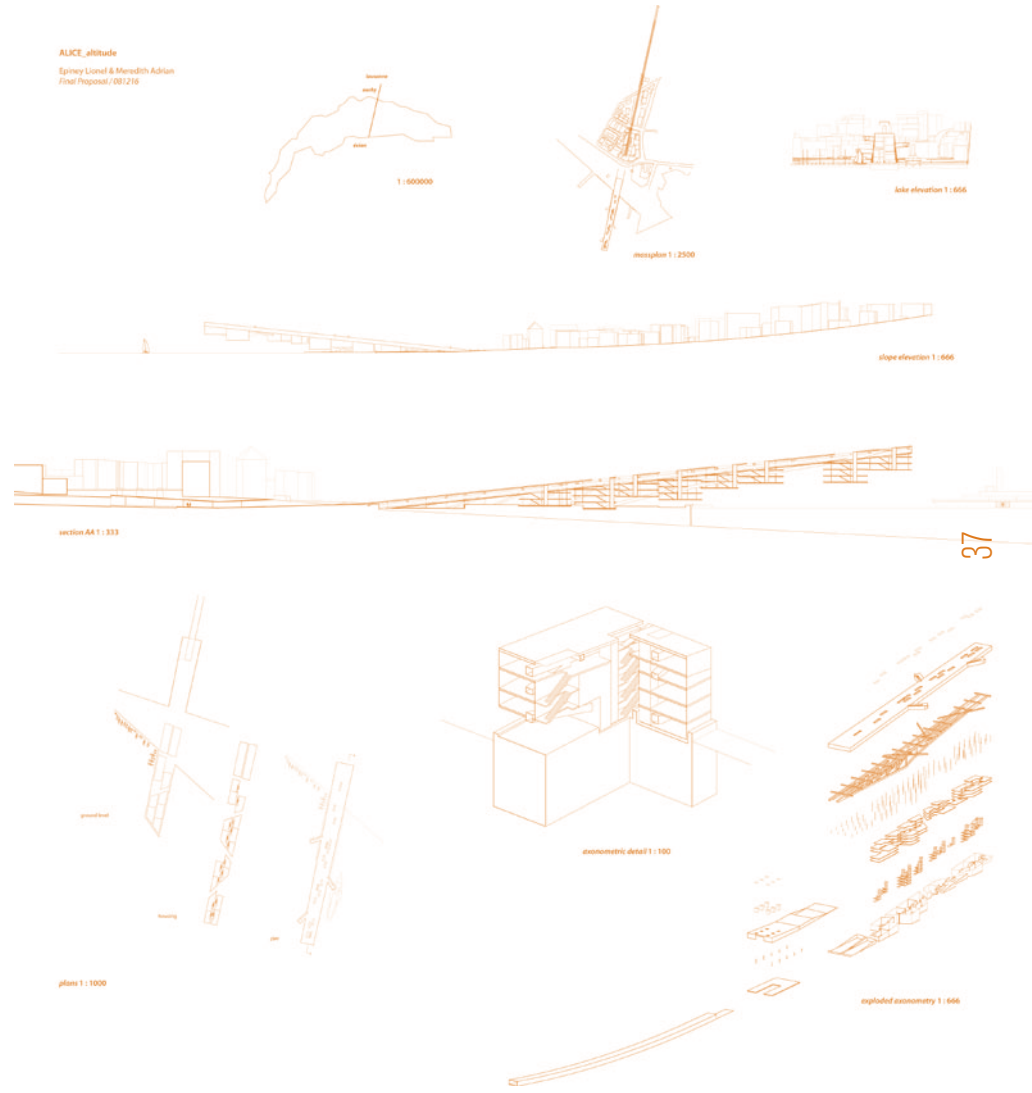

alice students 2008/2009

**Alexandria Ming Aerni, Ahmed Belkhadja, Augustin Clement,
Samuel Devanthéry, Lionel Epiney, Nicolas Feihl,
Olivier Di Giambattista, David Jenny, Eveline Job, Elias Kesselring,
Jonas Läubli, Martin Lepoutre, Samuel Maire, Lukas Manz,
Benjamin Melly, Adrian Llewelyn Meredith, Youcef Mezzour,
François Nantermod, Julien Prudhomme, Korab Ramadani,
Fabian Roth, Gabriela Schär, Danny Te Kloese, Barbara Thüler,
Hadrien Tricaud, Tom Doan Tuan, Vy Pham Thi Hoang,
Simon Wälti, Anina Weber, Carole Westhoff**

alice team

**Dieter Dietz, Aline Dubach, Eveline Galatis, Olivier Ottevaere,
Daniel Pokora, Isabella Pasqualini, Katia Ritz**

booklet, concept and design

Jonas Voegeli, Aline Dubach, Caroline Pachoud (Colour Concept)

38

many thanks to

**Raffael Baur, Renate Buser, Francesco Della Casa,
Hiéronyme Lacroix, Camilo Rebelo**

for inspiring critics and discussions.

special thanks to

**Marc Parlange, Doyen ENAC EPFL; Nicolas Henchoz,
Director EPFL+ECAL lab; Ines Lumunière, Director SAR, EPFL;
Bruno Marchand, Director IA, EPFL; Eveline Galatis,
ALICE lab EPFL**

for their wide spread support.

acknowledgments

39

**http://
alice.epfl.ch**